

STATE OF ALABAMA
JEFFERSON COUNTY

I, J. H. Keel a Registered Surveyor of Birmingham, Alabama hereby certify the foregoing markers at the corners of same as shown above; that the buildings now erected on said property are within

DESCRIPTION: Part of the south half of Section 19, T-17-S, R-2-W in the City of Birmingham in Jefferson C thence run southeasterly along the westerly line of 37th Street for 225.00 feet; thence 36th Place North; thence 90° 01' 30" right and run northwesterly along the easterly line of along the southerly line of 11th Avenue North for 660.10 feet to the point of beginning. Said of Blocks 2 and 3 according to J. D. Leake's Survey as recorded in Map Book 5, Page 4 in the alleyway between 10th Avenue North and 11th Avenue North to the southerly line of 11th Avenue

According to my survey this the 24th day of April, 1964.

sb No. 26322-B

Fontaine Truck Equipment Company
(Old Virginia Steel Co. Site)

J. H. Keel
J. H. Keel,
Reg. No. 610

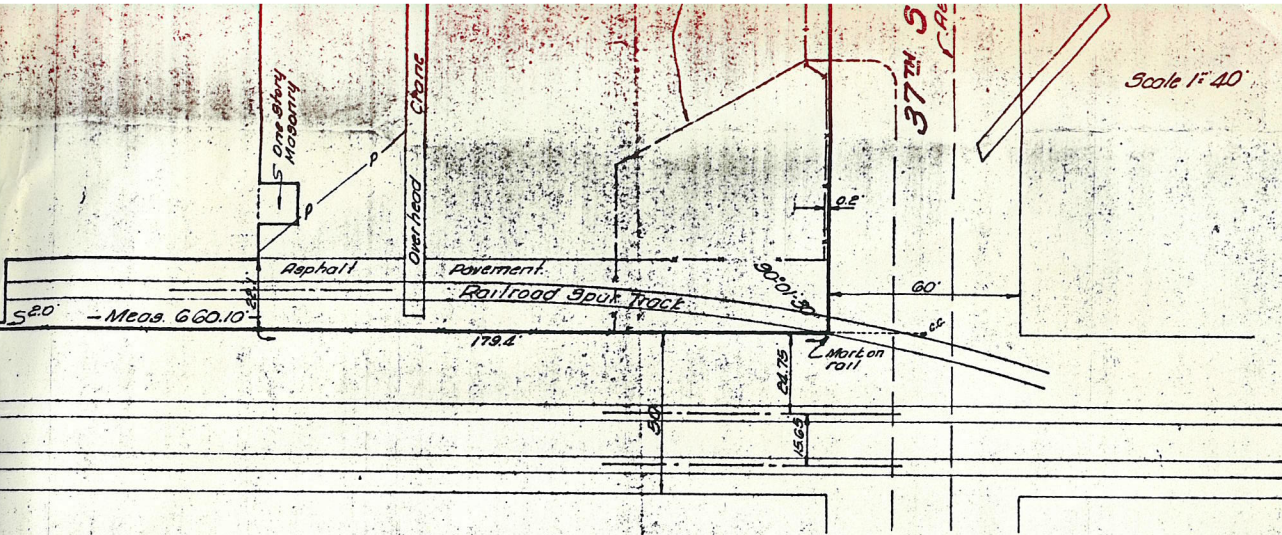

Scale 1" = 40'

37TH S

ct map or plat of the property shown above and as described below and that I have set iron pipe at there are no encroachments from adjoining properties.

t a point where the southerly line of 11th Avenue North intersects the westerly line of 37th Street, outwesterly along the northerly line of a 50 foot alleyway for 660.10 feet to the easterly line of 5.00 feet; to the southerly line of 11th Avenue North; thence 89° 58' 30" right and run northeasterly 32-A and 33-A according to the survey of East Birmingham as recorded in Map Book 1, Page 7 and part erson County, Alabama. Also a portion of 36th Way North as Vacated, extending northward from the ough said J. D. Leske's Survey.

Power & Telephone Poles & Lines, added June 5, 1964

J. D. Leske
J. D. Leske